

Wiring diagram

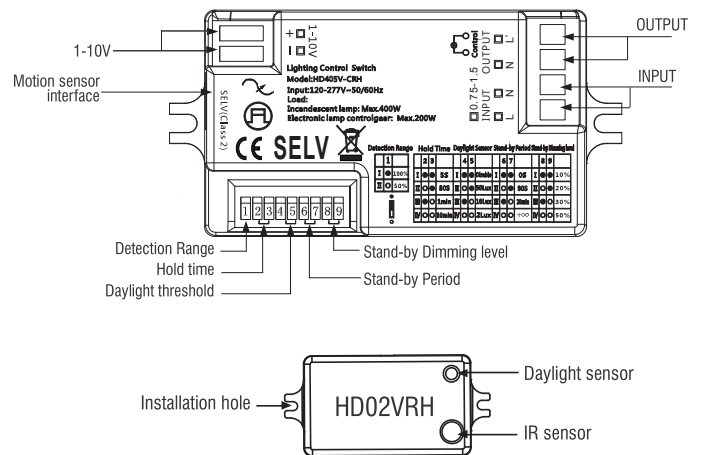

On/off control



Stand-by period



Detection area



Stand-by dimming level



Hold-time



Remote control setting



Daylight threshold

## 01 Technical data

Operating voltage	120~277 VAC 50/60Hz
Switching capacity	Max.200W(Control gear) Max.400W(Incandescent lamp)
Standby power	<1W
Detection area	50%/100%
Hold-time	5s/30s/1min/10min
Stand-by period	0s/30s/20min/+ ∞
Stand-by dimming level	10%/20%/30%/50%
Daylight threshold	2Lux/10Lux/50Lux /Disable
Microwave frequency	5.8GHz±75MHz
Microwave power	<0.3mW
Interfaces	6-pole pluggable clamp terminal (L,N,N,L,1-10v+,1-10v-)for 0.75-1.5mm <sup>2</sup> cable
Mounting height	Max.15m(ceiling mounted)
Detection range	Max.12x15m(ceiling mounted) Max.20m(wall mounted)
Operating temperature	-20°C ~ +55°C
IP rating	IP20
Size	90x45x23.2mm; HD02VRH,51x24.4x14mm
Certificate	cULus listed,FCC

Specifications subject to change without notice. ©All rights reserved.

Specifications subject to change without notice. ©All rights reserved.

## 02 Mechanical structure(mm)

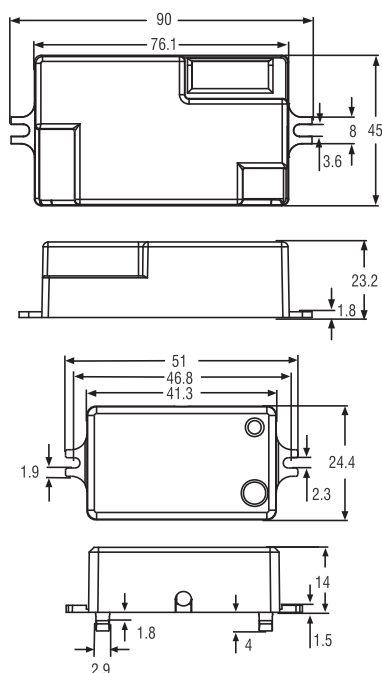

## 03 Settings

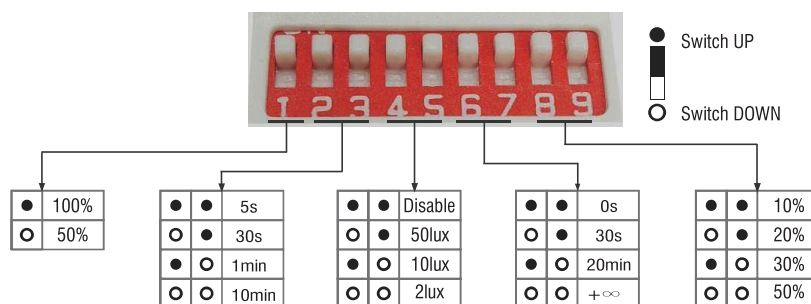

## Detection area

Detection area means detection coverage. It can be adjusted by combining DIP switches for specific application.

## Hold-time

Hold-time means the time period the light will be ON after the last detection.

## Daylight threshold

Daylight sensor prior to motion sensor. Set threshold for specific needs. If Disable, only motion sensor works.

## Stand-by period

This is the time period the light keeps dimming down after the last detection.

## Stand-by dimming level

This is the dimming level the light keeps during stand-by period.

Note: Motion sensor setting and dimming setting please refer to remote control HD02R. HD02VRH Standard Version Cable Length 30mm(can be customized).

## 04 Detection coverage

## Ceiling Mounted

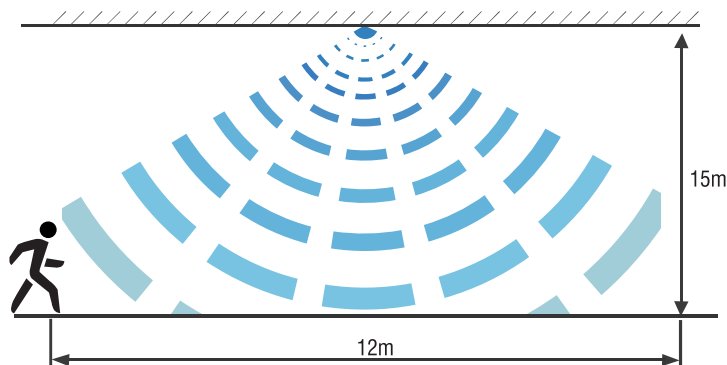

## Wall Mounted

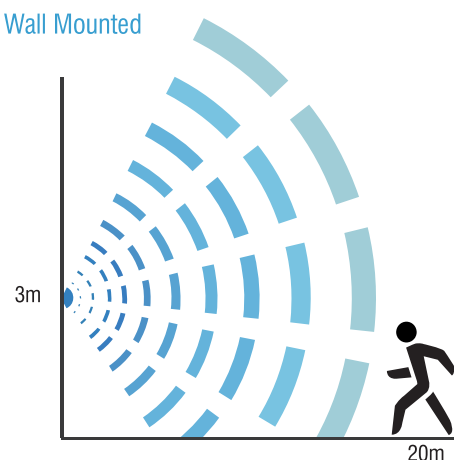

## 05 Application Function Demo - Dimmable control/Corridor function

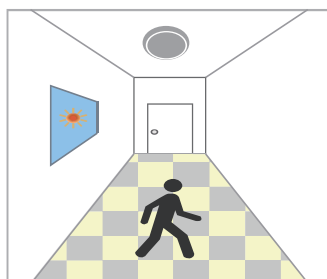

When motion detected, but sufficient daylight, light remains OFF.



When motion detected, insufficient daylight, light ON.

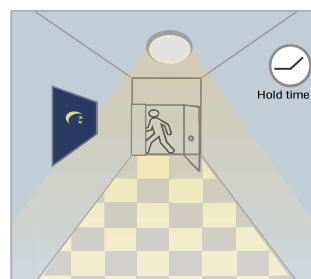

After last detection, the light will be dimmed down to the stand-by dimming level(10%,20%30%,50%).

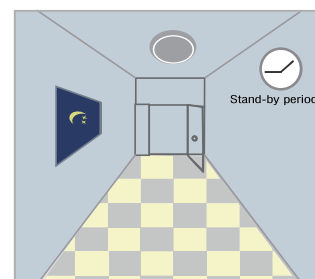

After the stand-by period, light OFF.